

Food Waste Disposal

SYS2000 Food Waste Pulper System



C55/C55T

- Food waste disposer and dewaterer in one integrated system • Designed for medium to large kitchens
- Free-standing with provision to connect to a trough • Compact with powerful 4.0kW disposer
- Processes up to 150kg of waste per hour • Recirculation process conserves water and saves costs
- Reduced waste volume means lower collection costs • Eliminates manual food waste separation

SYS2000 combines all the benefits of a high-capacity food waste disposer with a dewaterer which substantially reduces waste volume for collection. It is therefore ideal for use in areas where technical restrictions or local regulations prohibit the discharge of food waste

directly into drains. SYS2000 is also specified where water is scarce, metered or costly. This is because it recirculates water between the system's grinding and dewatering processes.

Preparation and table waste is scrapped into the disposer section. Under a flow of recycled water, waste is ground into particles which are passed automatically to the dewaterer. Here, they are squeezed to remove most of the water content. This water is then recirculated within the system, minimising water consumption. Meanwhile, the semi-dry waste is discharged into a suitable container.

SYS2000 eliminates time-consuming waste separation by hand, freeing staff to carry out more productive tasks. The system requires very little technical input. Its intelligent control system monitors a fully automatic operation. Routine cleaning and maintenance is quick, straightforward and requires no tools. The auger, tube and chute are easily removable and can be washed in a dishwasher or hosed clean.

Both models incorporate a safety baffle with interlock to protect the operator. Another innovative standard feature is a magnetic trap to intercept any cutlery accidentally dropped into the machine before it reaches the grinding unit.

Technical Specification

For shipping specifications please see pages 25-26

	C55/C55T
Capacity	Up to 150kg per hour
Disposer Motor	4.0kW
Dewaterer Motor	1.1kW
Total Loading	6.1kW
Voltages	380/415-3-50, 440-3-60
Fuse Rating	16A
Water Supply	15mm cold supply, 0.2-10 bar, and 15mm hot or cold supply (for sprays), 0.2-10 bar
Waste Connection	1 1/2" BSP female, for connection into 40mm pipework
Safety	Interlocked disposer cover and chute
Controls	Wall mounted ON/OFF control box. Fully automatic system fill, motor start and reverse, water recirculation and overflow. Manual water drain off
Other features	Auger spray system Trickle water feed Two chute positions



Trough Connection C55T



Auger and Screen

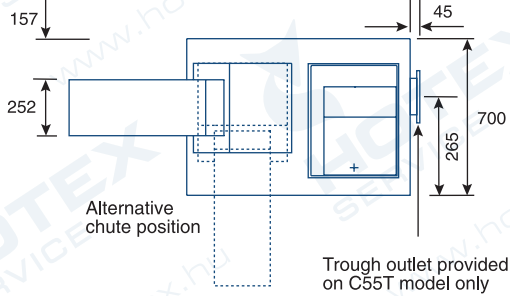
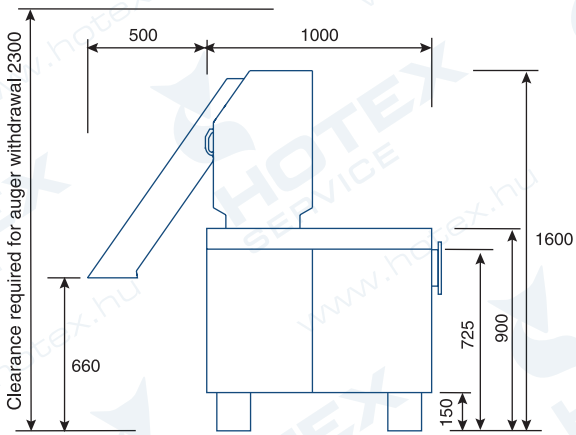

Typical Layout

Dimensions in mm
2.5m cable supplied

